



WOODBURY

UNIVERSITY

founded in 1884

RESIDENTIAL LIFE

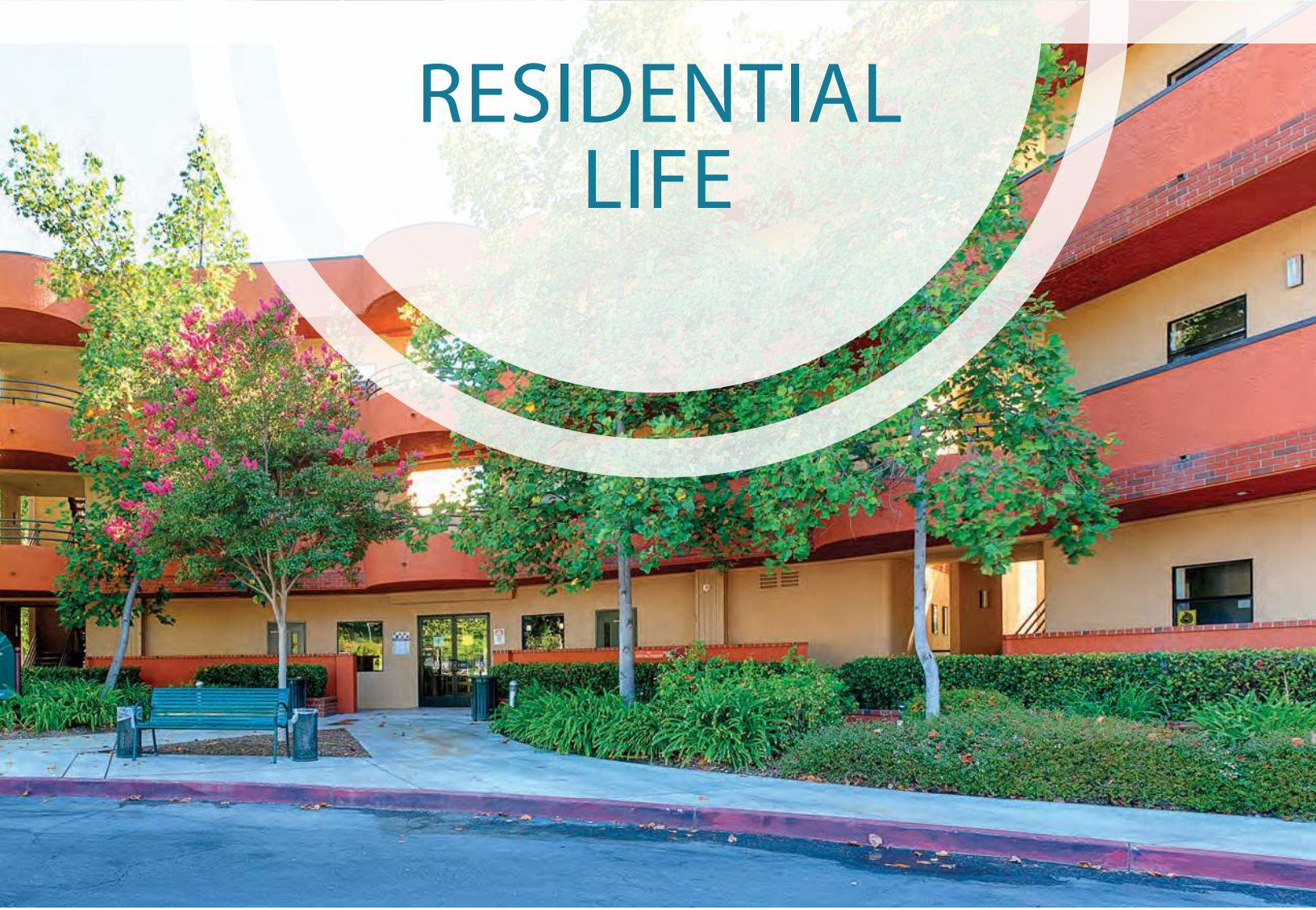



Everything you
need, in close
proximity.

WHY LIVE ON CAMPUS?

A great deal of learning is done outside of the classroom. In fact, research estimates that as much as 70% of on-campus time is spent outside the classroom! A lot of engaged learning takes place in the residence halls where students are challenged to learn more about themselves and how to live in a community. Living on campus allows students to transition from adolescence into adulthood in a safe environment. National research indicates that, in general, students who live on campus have a higher retention rate than those who reside off-campus.

Students who live on campus benefit from the many conveniences that the university offers: easy access to classes, food, recreational facilities, programs and activities. Studies from universities across the nation show that students who live on campus at any point during their post-secondary education are more involved in campus life and are more likely to complete their education. Students credit their higher grade point averages to a sense of community, class connection, and the shared experience of living and attending classes on campus with other students.

WHY WOODBURY?

Living on campus at Woodbury not only enhances the student's experience but it also creates long-lasting memories. The walking distance from the residence halls to the classrooms is in close proximity. Studio majors have no need to drive off campus to get sleep after a long night in studio. Students in the residence halls enjoy the activities arranged by the Resident Advisors and the Residence Hall Association.

CONTACT FOR MORE INFO



MARCO VALENZUELA
Director of Residential
and Greek Life
(818) 252-5295



MONIKA MARFECHUK
Administrative Assistant
to Residential Life
(818) 252-5117



/WoodburyResLife



@Woodburyhousing



/Woodburyhousing

STAY CONNECTED
WITH US ONLINE!

ROOM LAYOUTS



South Hall

South Hall Single (11 x 8'):

1. Closet
2. Bed
3. Chair
4. Desk
5. Dresser
6. Nightstand
7. Sink and Medicine Cabinet

South Hall Quad (19.5 x 12'):

1. Closet
2. Bed
3. Chair
4. Desk
5. Dresser

Pink = Quads
White = Singles



South Hall



South Hall Single



North Hall



North Hall Single

North Hall

North Hall Single (11 x 13'):

1. Closet and Dresser
2. Bed
3. Chair
4. Desk

North Hall Double (11 x 25'):

1. Closet and Dresser
2. Bunk Bed
3. Chair
4. Desk

North Hall Triple (11.5 x 13'):

1. Closet
2. Bunk Bed
3. Chair
4. Desk
5. Dresser

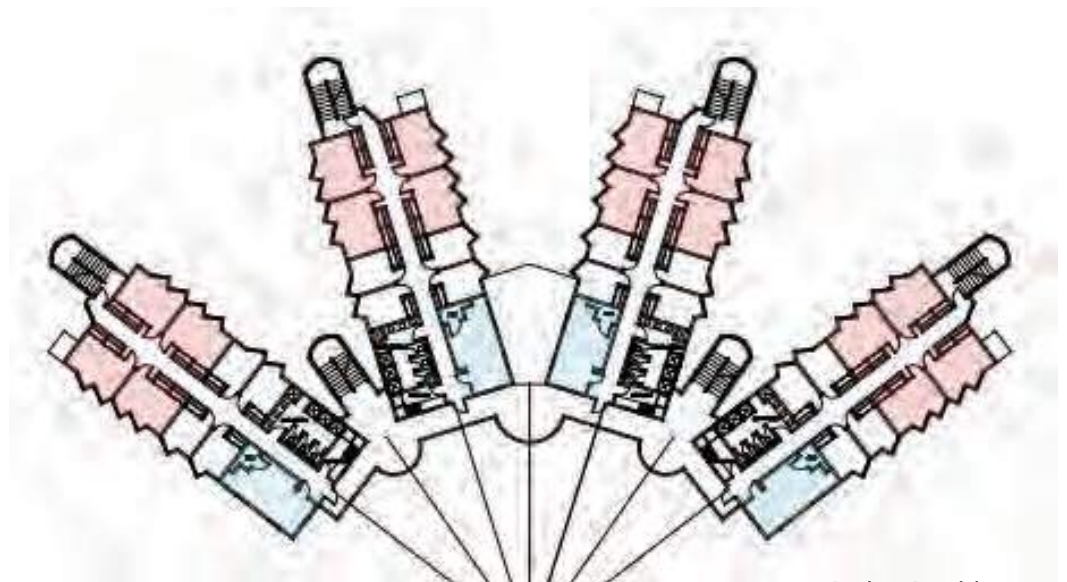

Pink = Doubles
Blue = Triples
White = Singles

FAQS

How do I apply for housing?

Apply online at the housing website. Complete instructions are available on this website: www.woodbury.edu/housing

How are roommates assigned?

For new freshmen and transfers who are starting in the fall, roommates are matched based on their profiles and building preferences.

Can I bring my own furniture?

Our residence halls are all furnished so there is little need for your own furniture. The furnishings provided may not be removed from your room.

What if I don't get along with my roommate?

We encourage roommates to work through initial concerns and perceptions of each other rather than expecting a roommate switch. RAs are always available to help resolve any roommate disagreements.

Do I have to move out during Winter Break?

Students living in residence halls are required to vacate their assigned rooms during the Winter Break, but not move out completely.

When may I cancel my contract?

Cancellation deadlines vary depending on your housing application. After the cancellation deadline you will be held to the terms of the housing contract. Housing contracts are generally for the full academic year. There are a few limited situations where a student may be allowed to cancel his/her housing contract and often there is a cancellation penalty.

Do I have to have a meal plan?

All residents living on campus are required to have a meal plan. A meal plan may be cancelled only if a resident moves out of the residence halls. If you have a dietary restriction please call the Office of Residential Life.



ResLife Staff



RHA Holiday Event

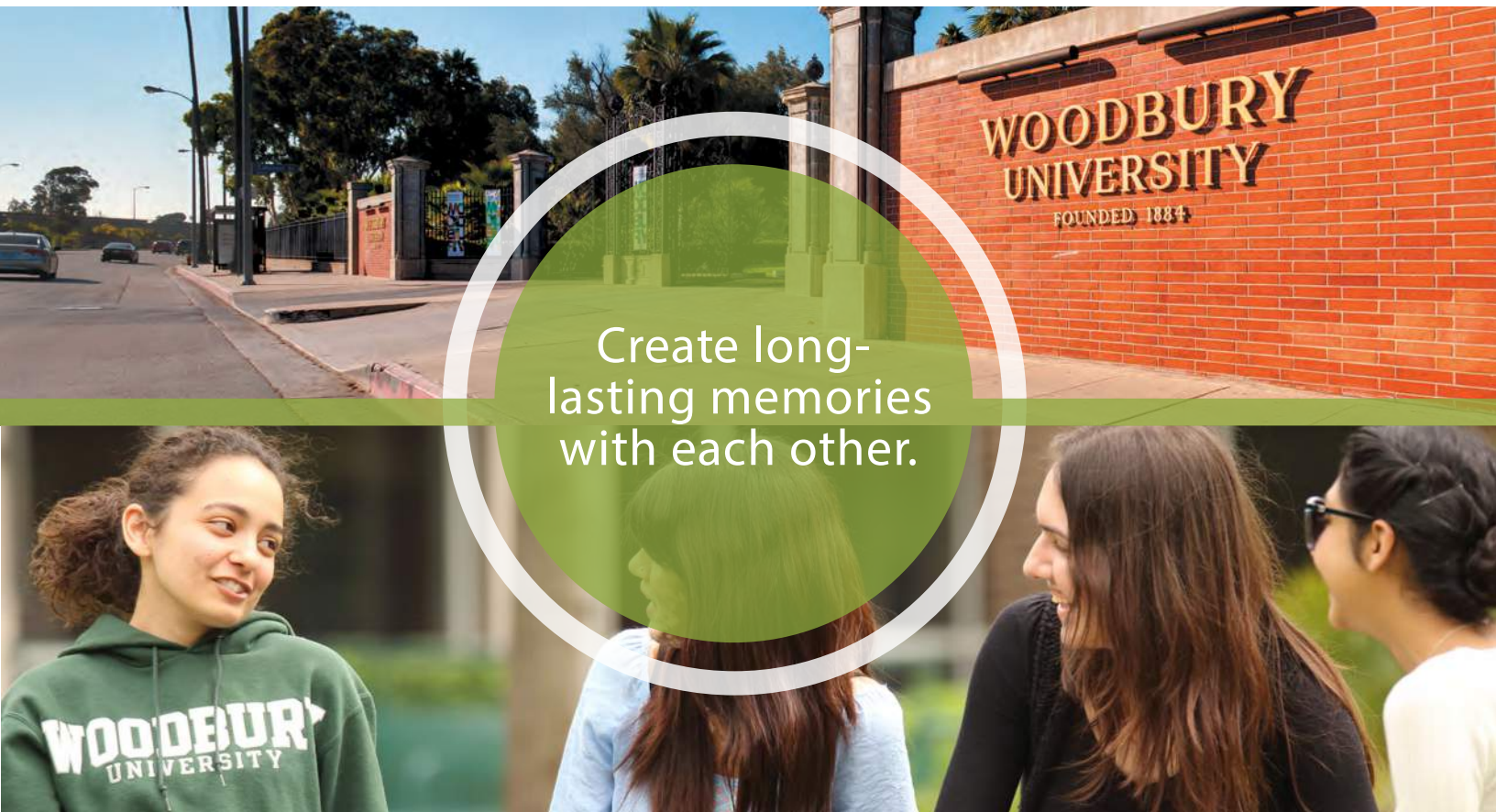

Create long-lasting memories with each other.



Year-round resident events and activities.

PROGRAMS

Woodbury University's Office of Residential Life offers plenty of on-campus excitement arranged by the Resident Advisors and the Residence Hall Association. Resident Advisors are trained student leaders who supervise those living in the residence halls. The Residence Hall Association is primarily concerned with programming activities for residents and providing advocacy and support to the residents.

AMENITIES

- Laundry Rooms
- Study Rooms
- Lobbies
- Cable
- Pool Access
- Air Conditioning
- Housekeeping
- WiFi
- 24/7 Security
- Gym
- Café Bon Appétit



2013 Escape to Paradise Luau



2013 Welcome Back Harry Potter Themed Dinner





FOR MORE INFORMATION

OFFICE OF RESIDENTIAL LIFE
7500 N Glenoaks Blvd.
Burbank CA, 91510

818.252.5253- Marco Valenzuela
818.252.2117- Monika Marfechuk

URL: www.woodbury.edu/housing

